

INSULATED DOOR

MODEL

Insulated Doors combine security with the option of insulation and sound control. Perfect for a multitude of Retail, Commercial and Industrial applications including Loading Docks, Water Treatment Plants, Manufacturing Facilities, Laboratories and any project that requires the additional benefit of insulation against both elements of weather and sound. Heavy duty, reliable construction, easily serviced in 24, 22, 20 and 18 gauge. Double skin interlocking roll formed metal slats filled with EPS-expanded polystyrene insulation, 8.0 R-Value.

SPECIFICATIONS

LISTINGS

- Therma Control with EPS-expanded polystyrene insulation, 8.0 R-Value.
- Sound Rated ASTM E90 / STC 26.
- Air-leakage Rated ASTM E282.
- Also available in Fire and Smoke Rating upon request.

SIZE

- 30' wide, 30' high standard construction. Large openings available of 60' wide or more, consult factory.

WEATHER STRIPPING

- All doors are supplied with rubber weather stripping on guides, bottom bar and inside hood for preventing intrusion by water, dust or pests. Additionally this enhances the thermal qualities of the door by preventing air leakage.

OPERATION

- Motor, Chain, Hand-Crank or Push-Up operation available based on size, weight or frequency of operation.
- Battery backup available to ensure operation in the event of power failure or blackout.

WINDLOAD

- Wind-rated for pressures for the following available upon request:

+60/-65 Wind Pressures
+65/-65 Wind Pressures
+100/-100 Wind Pressures



FAST ACTING DOORS

- For high traffic openings or where airflow or temperature control is critical, doors can be designed to operate at more than twice the speed of typical doors, or up to 2ft./sec.

USAGE

- Standard construction is up to 15,000 cycles per year with high cycle construction available for doors expected to be operated more than 15,000 cycles per year, i.e. parking garages and sally ports.

BOTTOM BARS

- Bottom bar options include: Single Angle, Double Angle, Tubular (extruded alum.) or "T" bottom bar.
- Bottom Bars have typical Mill Finish.

LOCKING

A. Chain Operation: Wall mounted chain keeper or zinc plated steel slide bolt with padlock provisions.

B. Push-Up or Hand-Crank Operation: Slidelocks, Round Locks or Cylinder Locks for locking at bottom bar (bottom bar design effects locking option available).

C. Motor Operator: No additional locking required as motor has automatic feature to prevent door from being lifted.

CONTACT US

Best Rolling Manufacturer, Inc. P: 305-698-3550
9780 NW 79 Avenue F: 305-698-3552
Hialeah Gardens, FL 33016 www.bestdoor.us

INSULATED DOOR

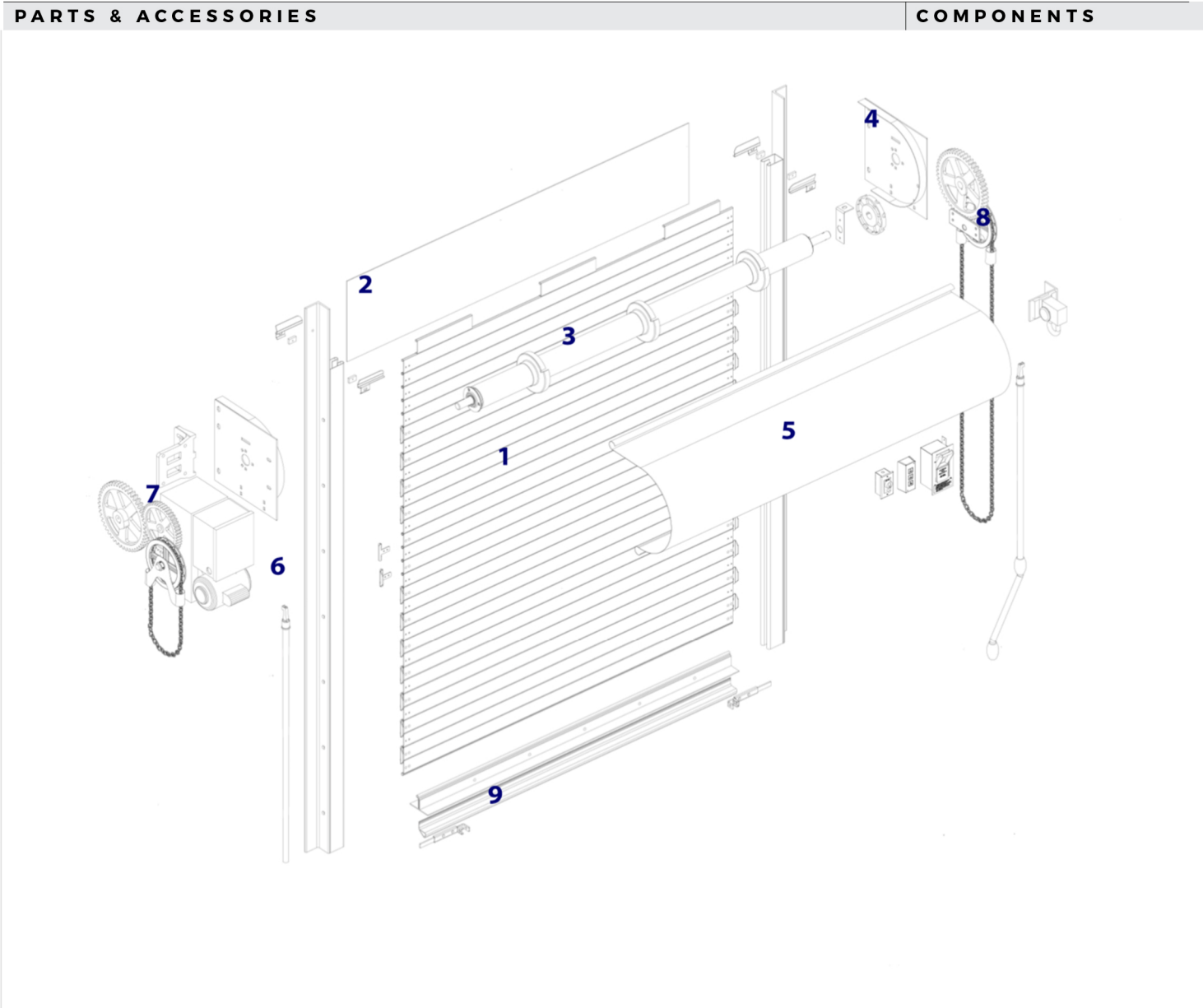

1. **CURTAIN** - Available in 2.5" regular slat.
2. **FASCIA** - Optional for installations with no header to cover exposed coil.
3. **TORSION - SPRING PIPE ASSEMBLY**
4. **HEAD PLATE** - Size varies based on door dimensions.
5. **COVER** - Standard round shape, supplied when coil is exposed.
6. **GUIDES** - Additional types and configurations available based on job type.
7. **MOTOR OPERATION** - Additional types and configuration available based on job type.
8. **CHAIN OPERATION** - Allow for minimum 5.0" sideroom clearance.
9. **BOTTOM-BAR** - Additional types, finishes and locking options available.