

# ROLLING SERVICE DOOR

## MODEL

Solid slat rolling doors are an economical, yet reliable means of protection against the elements, while providing the utmost in security. This Rolling Door is available in a variety of gauges and finishes, in steel or aluminum. Perfect for Loading Docks, Warehouse Facilities, Exterior Storefront Protection and more.

## SPECIFICATIONS

### LISTINGS

- This door qualifies for wind, fire, smoke and/or sound rating. Additional components required.

### SLATS

- Manufactured from 2.5" wide metal slats roll formed to interlace together to create a continuous steel curtain.  
- Slats are available in 24, 22, 20 and 18 gauge.

### OPERATION

- Motor, Chain, Hand-Crank or Push-Up operation available based on size, weight or frequency of operation.  
- Battery backup available to ensure operation in the event of power failure or blackout.

### MATERIALS & FINISHES

- Curtains have typical material construction of steel slats; aluminum, stainless steel or galvalume available upon request.  
- Standard finishes: Galvanized, Primed Grey and Primed White.  
- Powder Coating finishes available upon request at an additional cost.

### BOTTOM BARS

- Bottom bar options include: Single Angle, Double Angle, Tubular (extruded alum.) or "T" bottom bar.  
- Bottom Bars have typical Mill Finish.



### HOOD

- Hoods are typically furnished if the coil is exposed. If provided, hoods are Steel Galvanized Finish.  
- Additional Finish Options: Stainless Steel, Galvalume, Prime Painted and Powder Coated.  
- Standard shape is round cover; options for squares or hexagonal available upon request.

### GUIDE / TRACK CONFIGURATIONS

- Guides are typical Mill Finish.  
- Guides available in: Steel Angle, Roll Form and Aluminum Extruded.  
- Guides and Tracks configuration available in: Z-Guide, E-Guide and F-Guide. For custom configuration requirements consult factory.

### COVERS

- Motor cover available for preventing weather intrusions and security protection.  
- For hand operation different cover options are available for chain mechanism to accommodate weather intrusion, security protection and aesthetics.  
- Covers can be provided for all exposed mechanical parts, consult factory.

## CONTACT US

Best Rolling Manufacturer, Inc.  
9780 NW 79 Avenue  
Hialeah Gardens, FL 33016

P: 305-698-3550  
F: 305-698-3552  
[www.bestdoor.us](http://www.bestdoor.us)

# ROLLING SERVICE DOOR

PARTS & ACCESSORIES

COMPONENTS

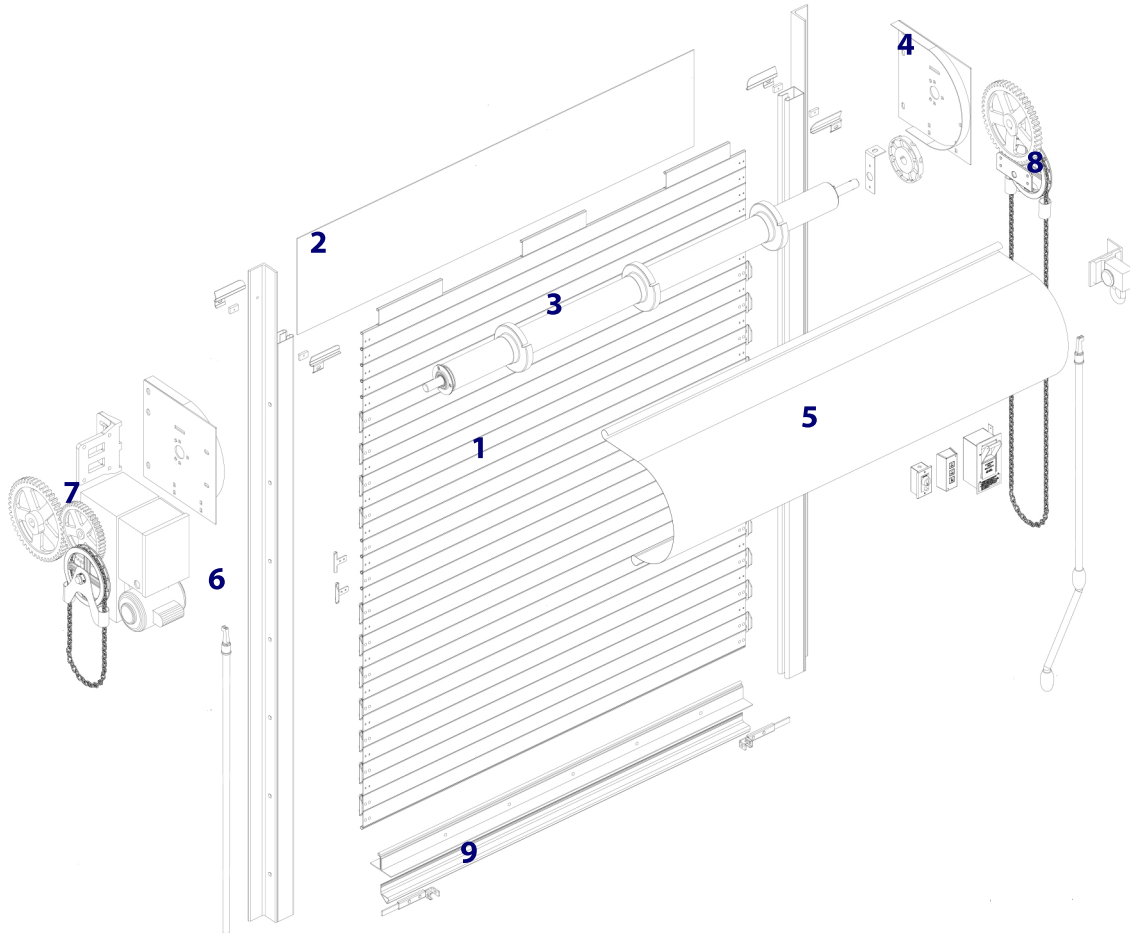

1. **CURTAIN** - Available in 2.5" regular slat.
2. **FASCIA** - Optional for installations with no header to cover exposed coil.
3. **TORSION - SPRING PIPE ASSEMBLY**
4. **HEAD PLATE** - Size varies based on door dimensions.
5. **COVER** - Standard round shape, supplied when coil is exposed.
6. **GUIDES** - Additional types and configurations available based on job type.
7. **MOTOR OPERATION** - Additional types and configuration available based on job type.
8. **CHAIN OPERATION** - Allow for minimum 5.0" sideroom clearance.
9. **BOTTOM-BAR** - Additional types, finishes and locking options available.